

<i>For Office Use Only</i>	
Date received:	
Scanned /Saved:	
Plotted:	
Site Ref:	
SHLAA Site Ref:	

'Call for Sites'

Warrington Borough Council Local Plan Review

Call for Sites Registration Form

October 2016

Please note this 'Call for Sites' is for five or more dwellings or economic development on sites of 0.25 ha (or 500sqm of floor space) and above, Gypsy, Traveller and Show People and Minerals and Waste sites.

The identification of sites does not imply that the Council considers that the site is suitable for development, either now or in the future. It cannot be taken as representing either an intention to allocate these sites, or as a material consideration in the determination of a planning application.

Potential sites that have been identified will be further tested through the Plan-making process, including through the Spatial Distribution and Site Assessment Process, Sustainability Appraisal/Strategic Environmental Assessment, several stages of public participation and independent examination.

Please also note that all the responses and information received as part of the 'Call for Sites' will be published and made available for public viewing as part of the open and transparent Plan making process.

NOTE: Please read the accompanying guidance note [here](#) before completing this form and complete a **separate** form for each site that you are submitting to the Council.

Please return your completed form and any accompanying supporting material to Planning Policy, Warrington Borough Council no later than 5.00pm on Monday 05th December 2016.

By e-mail: ldf@warrington.gov.uk

By post: Planning Policy, Warrington Borough Council, New Town House, Buttermarket Street, Warrington, WA1 2NH

Should you require further advice and guidance on completing this form, please contact the Planning Policy Team by telephone on 01925 442841 or by e-mail to ldf@warrington.gov.uk

(1) Your Details

Please provide your contact details and those of your agent (if applicable). Where provided, we will use your Agent's details as our primary contact.

	Your details	Your Agent's details
Name		
Position		
Organisation		
Address		
	Town	
	Postcode	
Telephone		
Email address		

(2) Site Details

Please provide the details of the site you are suggesting. If you are suggesting more than one site, please use a **separate** form.

Name of site /other names it's known by		
Address		
	Town	
	Postcode	
Ordnance Survey Grid Reference	Easting :	Northing :
Site area (hectares)		
Net developable area (hectares)		
What is your interest in the site? (please tick one)	Owner	Lessee
	Prospective Purchaser	Neighbour
	Other	Please state:

Please Note: It is essential that you provide a map showing the site's location and detailed boundaries for each submission.

(3a) Proposed future use(s)

Please indicate the preferred use that you would like the site to be considered for. Please also indicate any other uses you would consider acceptable. If you wish the site to be considered for a mix of uses, please tick all uses that apply.

	Residential	Gypsy & Travellers	Employment	Retail	Leisure	Other*	
Preferred future use							
Alternative future use(s)							
Potential Capacity	houses:	Number of Pitches:	SqM	SqM	SqM	SqM	
	or flats:						
Employment Use Class (E.g. B1)							
* If "Other", please indicate which use(s):							
Potential Density							
	Has any design, viability, master planning work or other studies been undertaken for any proposed use?			Yes	No		

(3b) Proposed future use(s) - Minerals and Waste

Details:

(4) Site Ownership

Please record the site ownership details. If there are more than three owners, please record the fourth owner, etc. on a separate sheet. Please indicate the extent of individual landholding(s) on the site map.

If you do not know who owns the site, please state so below.

	Owner 1	Owner 2	Owner 3
Name			
Address			
	Town		
	Postcode		

Or: I do not know who owns the site

Has the owner (or each owner) indicated support for proposed redevelopment?

Please also record these details for the 4th and subsequent owners (where necessary).

Yes			
No			
Don't know			

Are there any Restrictive Covenants & Ransom Strips affecting the site?

--

(5) Market Interest

Please choose the most appropriate category below to indicate what level of market interest there is in the site:

		Any comments
Site is owned by a developer		
Site under option to a developer		
Enquiries received		
Site is being marketed		
None		
Not known		

--

(6) Site Condition

Please record the current use(s) of the site (or for vacant sites, the previous use, if known) and the neighbouring land uses.

Current use(s)		
Neighbouring Uses		
If vacant	Previous use(s)	
	Date last used	

What proportion of the site is made up of buildings, and what proportion is (open) land?

Proportion covered by buildings	%	Proportion not covered by buildings	%
---------------------------------	---	-------------------------------------	---

If there are buildings on the site, please answer the following questions:

How many buildings are there on the site?		buildings
What proportion of the buildings are currently in use?	% in use:	%
	% derelict:	%
	% vacant:	%
Are any existing buildings on the site proposed to be converted?		

For the **parts of the site not covered by buildings**, please answer these questions:

What proportion of the land is currently in active use?		%
What proportion is greenfield (not previously developed)?		% (A)*
What proportion is previously developed and cleared?		% (B)*
What proportion is previously developed but not cleared? (e.g. demolition spoil, etc.)		% (C)*

* A plus B plus C should add to 100%.

Please provide any additional comments on a separate sheet if necessary.

(7) Constraints to Development

Please tell us about any known constraints that will affect development for the proposed use, details of what action is required, how long it will take and what progress has been made.

Please use a separate sheet where necessary to provide details. If using separate sheets, it would be helpful to make reference there to the particular constraint, e.g (7)(e) – Drainage.

	Yes, No or Don't know	Nature and severity of constraint *	Action needed, timescales and progress	Confirmed by technical study or by service provider?	
				Yes	No
a) Land contamination					
b) Land stability					
c) Mains water supply					
d) Mains sewerage					
e) Drainage, flood risk					
f) Tree Preservation Orders					
g) Electricity supply					
h) Gas supply					
i) Telecommunications					
j) Highways					
k) Ownership, leases etc.					
l) Ransom strips, covenants					
m) Other (Please provide details)					

(8) Site Availability

Please indicate when the site may be available

Excluding planning policy constraints, when do you believe this site could be available for development?

Immediately

(Note: to be "immediately available", a site must be cleared, unless being considered for conversions.)

If not immediately, please state when it could be available:

If the site is not available immediately, please explain why – e.g. the main constraint(s) or delaying factor(s) and actions necessary to remove these:

(9) Any Other Information

Please tell us anything else of relevance regarding this site if not already covered above that will ensure that it contributes positively to the achievement of sustainable development. Please use a separate sheet/s if necessary.

**Planning Policy– Warrington Borough Council,
New Town House, Buttermarket Street, Warrington, WA1 2NH**

ldf@warrington.gov.uk

01925 442841

This form is available in other formats or languages on request.

notes:

This drawing is the copyright of Paddock Johnson Partnership Limited and may not be used without their prior written consent
Written dimensions to be taken in preference to scaled dimensions
Due to the inaccuracies of scanning, scanned images should not be scaled

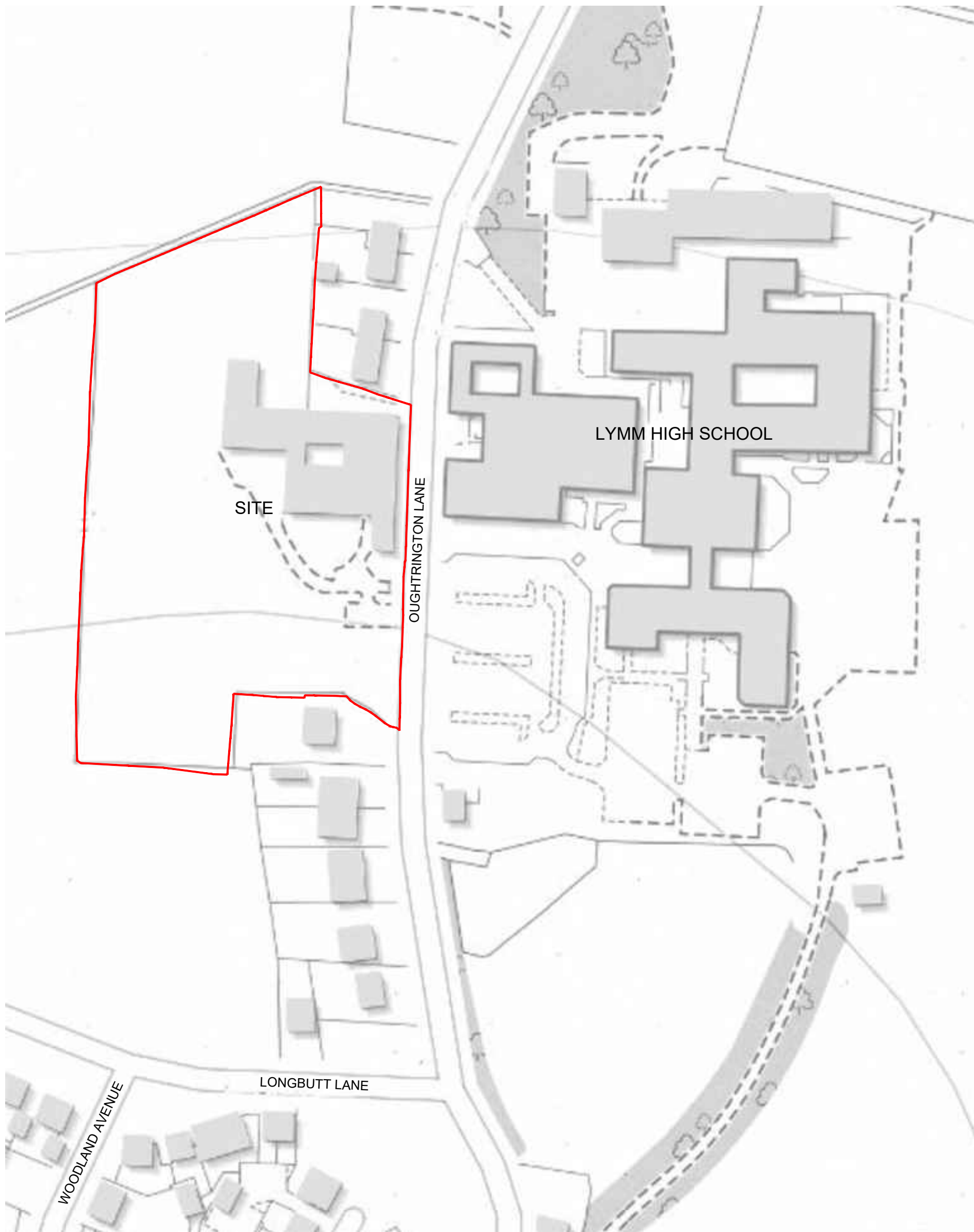

rev	date	description	by

status:

PRELIMINARY

client: Lane End Developments

drawing no: **15107-113**

scale: 1:1250 sheet: A3

project: Residential Development
Oughttrington Lane, Lymm

drawing title: Site Location Plan

date: 15/09/16 by: SD
checked: SH

paddock johnson partnership
architects

Studio 2, The Lyceum, Bath Street, Port Sunlight, Wirral CH62 4UJ
e: enquiry@paddockjohnson.com w: www.paddockjohnson.com
t: +44(0)151 643 1234 f: +44(0)151 643 1666

\\ppdc04\cubefiles\generated docs\15107\drawings\113\15107-113\000\15107-113-000-001.dwg 6 3:52 PM

Paddock Johnson Partnership Limited Registered England and Wales No.06684275 Address as above